

PRODUCT INFORMATION PACKET

Model No: TCAP751A3111GACD01
Catalog No: TCAP751A3111GACD01

0.75 kW General Purpose Low Voltage IEC Motor, 3 phase, 3000 RPM, 415 V, 80M Frame, TEFC
Cast Iron IE3 Efficiency Motors





Nameplate Specifications

| | | | |
|----------------------------|--------|------------------------|-----------------------------|
| Output HP | 1 Hp | Output KW | 0.75 kW |
| Frequency | 50 Hz | Voltage | 415 V |
| Current | 1.6 A | Speed | 2881 rpm |
| Service Factor | 1 | Phase | 3 |
| Efficiency | 80.7 % | Power Factor | 0.82 |
| Duty | S1 | Insulation Class | F |
| Frame | 80M | Enclosure | Totally Enclosed Fan Cooled |
| Ambient Temperature | 50 °C | Drive End Bearing Size | 6204 |
| Opp Drive End Bearing Size | 6204 | UL | No |
| CSA | No | CE | Yes |
| IP Code | 55 | | |

Technical Specifications

| | | | |
|-----------------------|---------------|-----------------------|----------------|
| Electrical Type | Squirrel Cage | Starting Method | Direct On Line |
| Poles | 2 | Rotation | Bi-Directional |
| Mounting | B3 | Motor Orientation | Horizontal |
| Drive End Bearing | 2z-C3 | Opp Drive End Bearing | 2z-C3 |
| Frame Material | Cast Iron | Shaft Type | Keyed |
| Overall Length | 281 mm | Frame Length | 140 mm |
| Shaft Diameter | 19 mm | Shaft Extension | 40 mm |
| Assembly/Box Mounting | Top | | |
| Connection Drawing | 8442000085 | Outline Drawing | 0208000179 |

This is an uncontrolled document once printed or downloaded and is subject to change without notice. Date Created:06/01/2020

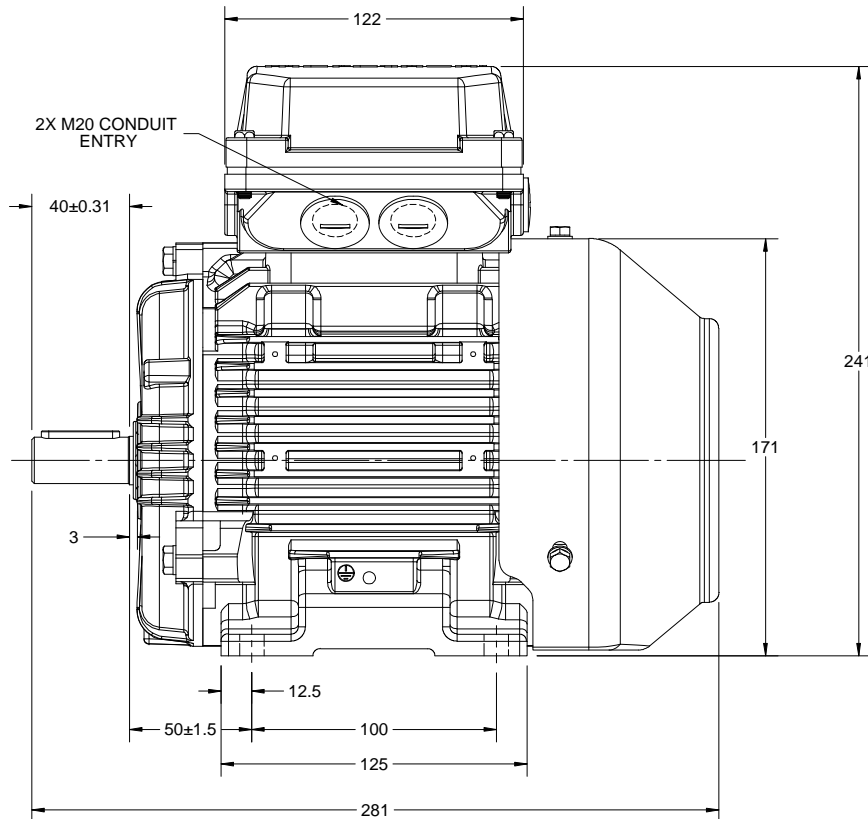
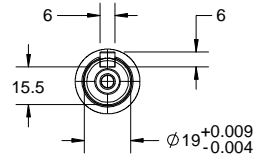
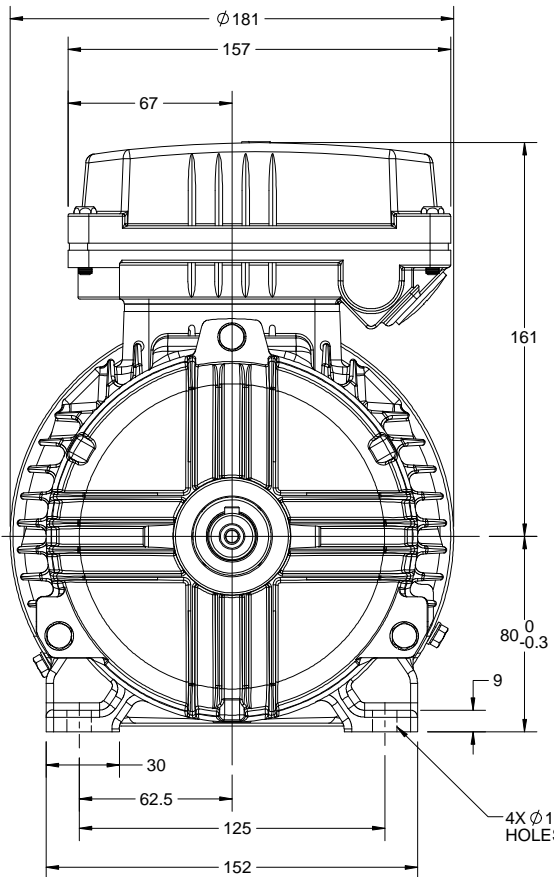

| | | |
|---|------------------------|--------------------|
| DRAWING REVISION C | REVISION BY S.MUDDA | DATE 20/06/2018 |
| ECO ECO-0147359 | APPROVED BY JAY | DATE 20/06/2018 |
| ECO DESCRIPTION OUTLINE UPDATED AS PER THE NEW 3D STRUCTURING | | |
| <small>COPYRIGHT REGAL BELOIT AMERICA, INC. ALL RIGHTS RESERVED. PROPRIETARY AND CONFIDENTIAL INFORMATION - THIS DOCUMENT IS THE PROPERTY OF REGAL BELOIT AMERICA, INC. ("OWNER") AND CONTAINS OWNER'S PROPRIETARY INFORMATION. ANY PERSON, CORPORATION OR OTHER FIRM RECEIVING IT IS DEEMED, BY RECEIVING IT, TO AGREE THAT IT, AND/OR ANY PART OF IT, SHALL NOT BE DISCLOSED TO ANY PERSON, CORPORATION OR OTHER ENTITY, DUPLICATED, AND/OR USED, EXCEPT AS EXPRESSLY APPROVED IN WRITING IN ADVANCE BY OWNER. THIS DOCUMENT SHALL BE RETURNED TO OWNER UPON REQUEST. IT MAY BE SUBJECT TO CERTAIN RESTRICTIONS UNDER APPLICABLE EXPORT CONTROL LAWS AND REGULATIONS.</small> | | |

| | |
|-------------------------------------|--|
| DRAWN BY SMAR | marathon Motors |
| DATE 21/06/2013 | |
| APPROVED BY JAY | DESCRIPTION OUTLINE 80 FR- B3 MTG. MOTOR TYPE TCA/QCA |
| DATE 30/08/2013 | MATERIAL |
| REFERENCE | PROCESS/FINISH |
| THIRD ANGLE PROJECTION | SIZE B |
| DRAWING NUMBER 0208000179 | SHEET 1 OF 1 |

Model No. TCAP751A3111GACD01

| U (V) | Δ / Y Conn | f (Hz) | P | | I | | n [RPM] | T [Nm] | IE Class | % EFF at __ load | | | | PF at __ load | | | I _L /I _N [pu] | T _M /T _N [pu] | T _L /T _N [pu] |
|----------|---------------|-----------|------|------|-----|------|------------|-----------|-------------|------------------|------|-------|-------|---------------|-------|-------|--|--|--|
| | | | [kW] | [hp] | [A] | [hp] | | | | 5/4FL | FL | 3/4FL | 1/2FL | FL | 3/4FL | 1/2FL | | | |
| 415 | Y | 50 | 0.75 | 1.0 | 1.6 | 2881 | 2.47 | | IE3 | - | 80.7 | 80.7 | 75.8 | 0.82 | 0.75 | 0.61 | 6.5 | 3.1 | 3.4 |
| | | | | | | | | | | | | | | | | | | | |

| | | | |
|----------------------------------|----------------------------|---|--|
| Motor type | TCA | Degree of protection | IP 55 |
| Enclosure | TEFC | Mounting type | IM B3 |
| Frame Material | Cast Iron | Cooling method | IC 411 |
| Frame size | 80M | Motor weight - approx. | 18.5 kg |
| Duty | S1 | Gross weight - approx. | 19.5 kg |
| Voltage variation * | ± 10% | Motor inertia | 0.0013 kgm ² |
| Frequency variation * | ± 5% | Load inertia | Customer to Provide |
| Combined variation * | 10% | Vibration level | 1.6 mm/s |
| Design | N | Noise level (1meter distance from motor) | 56 dB(A) |
| Service factor | 1.0 | No. of starts hot/cold/Equally spread | 2/3/4 |
| Insulation class | F | Starting method | DOL |
| Ambient temperature | -20 to +50 °C | Type of coupling | Direct |
| Temperature rise (by resistance) | 70 [Class B] K | LR withstand time (hot/cold) | 7/15 s |
| Altitude above sea level | 1000 meter | Direction of rotation | Bi-directional |
| Hazardous area classification | NA | Standard rotation | Clockwise form DE |
| Zone classification | NA | Paint shade | RAL 5014 |
| Gas group | NA | Accessories | |
| Temperature class | NA | Accessory - 1 | - |
| Rotor type | Aluminum Die cast | Accessory - 2 | - |
| Bearing type | Anti-friction ball bearing | Accessory - 3 | - |
| DE / NDE bearing | 6204-2Z / 6204-2Z | Terminal box position | TOP |
| Lubrication method | Greased for life | Maximum cable size/conduit size | 1R x 3C x 10mm ² /2 x M20 x 1.5 |
| Type of grease | NA | Auxiliary terminal box | NA |

I_L/I_N - Locked Rotor Current / Rated Current

T_M/T_N - Breakdown Torque / Rated Torque

T_L/T_N - Locked Rotor Torque / Rated Torque

NOTE

All performance values at rated voltage and frequency.

All performance parameters are subjected to standard tolerance as per IEC 60034-1

* Voltage, Frequency and combine variation are as per IEC60034-1

Technical data are subject to change. There may be discrepancies between calculated and name plate values.

| Efficiency Standards | Europe | China | India | Aus/Nz | Brazil | Global IEC |
|----------------------|--------|-------|-----------------|--------|--------|------------|
| | - | - | IS 12615 : 2018 | - | - | - |

Model No. TCAP751A3111GACD01

| Enclosure | U [V] | Δ /Y Conn | f [Hz] | P [kW] | P [hp] | I [A] | n [RPM] | T [kgm] | T [Nm] | IE Class | Amb Temp [°C] | Duty | Elevation [m] | Inertia [kg·m ²] | Weight [kg] |
|-----------|-------|------------------|--------|--------|--------|-------|---------|---------|--------|----------|---------------|------|---------------|------------------------------|-------------|
| TFC | 415 | Y | 50 | 0.75 | 1.0 | 1.6 | 2881 | 0.25 | 2.47 | IE3 | 50 | S1 | 1000 | 0.0013 | 18.5 |

Motor Load Data

| Load Point | NL | 1/4FL | 1/2FL | 3/4FL | FL | 5/4FL |
|--------------|-------|-------|-------|-------|------|-------|
| Current | A | 0.8 | 0.9 | 1.1 | 1.3 | 1.6 |
| Torque | Nm | 0.0 | 0.8 | 1.6 | 2.5 | 2.5 |
| Speed | r/min | 3000 | 2969 | 2943 | 2914 | 2881 |
| Efficiency | % | 0.0 | 64.5 | 75.8 | 80.7 | 80.7 |
| Power Factor | % | 15.8 | 43.9 | 61.0 | 75.0 | 82.0 |

Performance vs Load Chart

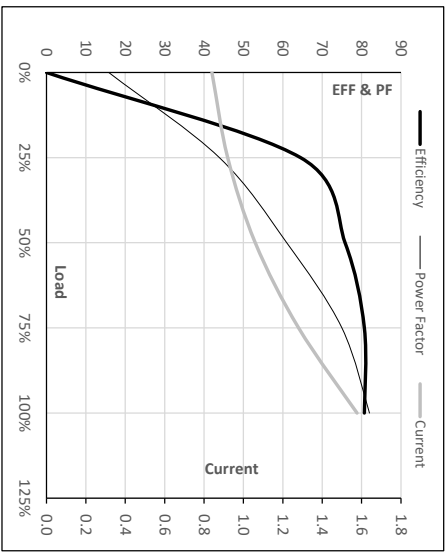

Starting Characteristics Chart

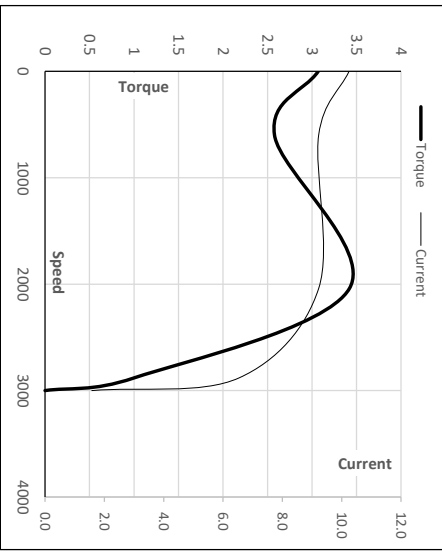

Motor Speed Torque Data

| Load Point | LR | P-Up | BD | Rated | NL | |
|------------|-------|------|-----|-------|------|------|
| Speed | r/min | 0 | 600 | 2041 | 2881 | 3000 |
| Current | A | 10.2 | 9.2 | 6.5 | 1.6 | 0.8 |
| Torque | pu | 3.1 | 2.6 | 3.4 | 1 | 0 |

NOTE Refer data sheet for applicable standard and tolerances on performance parameters

Issued By
Issued Date

Model No. TCAP751A3111GACD01

| | | | | | | | | | | | | | | | |
|-----------|-----|-------|----|------|------|-----|-------|-------|------|-------|------|------|-----------|----------------------|--------|
| Enclosure | U | Δ / Y | f | P | P | I | n | T | T | IE | Amb | Duty | Elevation | Inertia | Weight |
| (V) | 415 | Y | 50 | [kW] | [hp] | [A] | [rpm] | [kgm] | [Nm] | Class | [°C] | S1 | [m] | [kg·m ²] | [kg] |
| TEFC | | | | 0.75 | 1.0 | 1.6 | 2881 | 0.25 | 2.47 | IE3 | 50 | | 1000 | 0.0013 | 18.5 |

Motor Speed Torque Data

| Load | FL | I ₁ | I ₂ | I ₃ | I ₄ | I ₅ | LR |
|----------|----|----------------|----------------|----------------|----------------|----------------|-----|
| TWT Hot | s | 10000 | 23 | 15 | 12 | 9 | 8 |
| TWT Cold | s | 10000 | 49 | 33 | 25 | 20 | 18 |
| Current | pu | 1 | 2 | 3 | 4 | 5 | 5.5 |
| | | | | | | | 6.5 |

Thermal Characteristics Chart

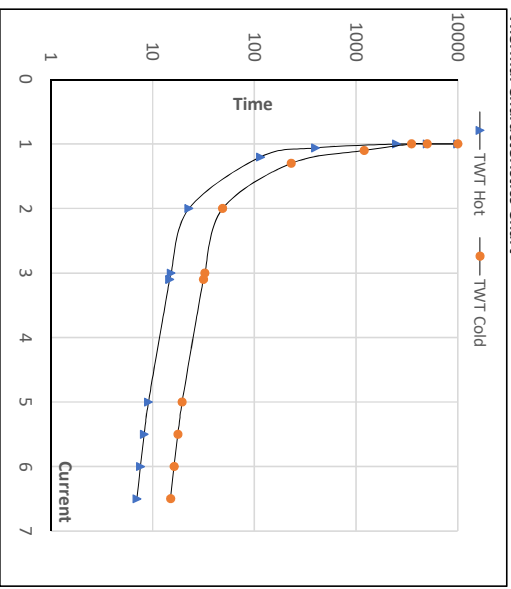

NOTE Refer data sheet for applicable standard and tolerances on performance parameters

Issued By
Issued Date